

2P TRIPLEX HOUSING FILTERS

The 2P housing is designed for water purification for residential and commercial applications. The bowl is made of PET material, which guarantees reliability and durability.

The 2P housing is equipped with a centralizing ring for cartridges. The ring keeps your cartridge centered and makes replacement procedure easy and fast.

KEY FEATURES

- "Stop thread" prevents overtightening of bowl and o-ring
- Internal centrator to ensure proper orientation of the cartridge
- Less pressure drop through "star-like" head design
- Compatible with three cartridge designs: DOE, BIG, COD3
- Smart placement of the wrench in the bracket avoids its loss

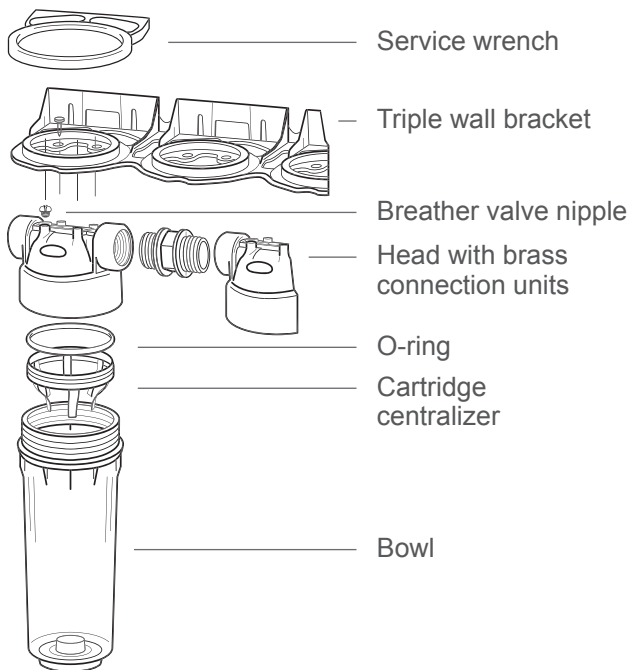

DATA SHEET

Head	PP with brass connection units
Nut	Threaded
Bowl	PET*
O-ring	EPDM
Max working pressure	8 bar
Max working temperature	From 5°C (41°F) to 50°C (122°F)
Bracketing	Horizontal
Fastening	Axle base fixing hole 40x32 mm hole for screws 3 mm
Connection	Screw thread in inch
Package	Empty housing without filter cartridge

made in 
ITALY

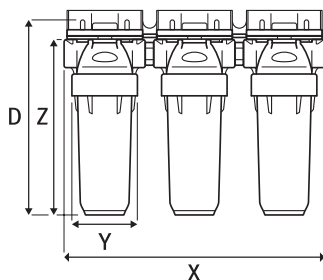

Code	IN/OUT threads	Size	Z	X	Y	D
FTPP2P0130	3/4"	9" 3/4	29.6 cm	40.1 cm	10.7 cm	33.0 cm
FTPP3P0110	1"	9" 3/4	30.1 cm	40.1 cm	10.7 cm	33.0 cm

Code	Description	Gross weight, kg	Unit packing dimensions, m			Pieces in box	Pieces on pallet
			Length	Width	Height		
FTPP2P0130	2P housing ECO 9" 3/4 TRIPLEX – 3/4" transparent PET bowl	3.2	0.405	0.16	0.35	5	90
FTPP2P0150	2P housing ECO 9" 3/4 TRIPLEX – 1" transparent PET bowl						

*Polyethylene terephthalate