

ECOSOFT RESIDENTIAL REVERSE OSMOSIS MEMBRANE ELEMENTS

DESCRIPTION:

Ecosoft residential reverse osmosis membrane elements are made to provide pure and tasty drinking water with stable high quality.

KEY FEATURES:

- Industry's leading membrane flat sheet manufactured in the USA
- Up to 20% higher performance and up to 20 min faster storage tank fill compared to many competitive products
- High stabilized salt rejection — 96%
- High capacity even in cold water
- Highly consistent quality membrane winding thanks to automated manufacturing line
- Every Ecosoft membrane element is individually vacuum tested



TECHNICAL DATA AND OPERATIONAL PARAMETERS

Code	Element Type	Average permeate flow rate, L/h (GPD)	Stabilized Salt Rejection, %	Applied pressure, bar (psi)
CSV181250ECO	50 GPD	7.9 (50)	96	3.4 (50)
CSV181275ECO	75 GPD	12.0 (75)		3.4 (50)
CSV1812100ECO	100 GPD	15.8 (100)		3.4 (50)
CSV3012500ECO	500 GPD	78.0 (500)		4.8 (70)

1. Permeate flow and salt rejection based on the following test conditions: 250 ppm softened tap water, 25 °C (77 °F), 15% recovery (40% for 500 GPD membrane) and the specified applied pressure
2. Minimum salt rejection is 94%
3. Permeate flow for individual elements for warranty evaluation may vary ±20%

MEMBRANE ELEMENTS DIMENSIONS

Element Type	A	B	C	D	E
50 GPD		236±2 mm (9.29±0.07")	Ø 45±2 mm (1.775±0.07")		
75 GPD	297±1 mm (11.73±0.037")			22±2 mm (0.87±0.07")	Ø 17±0.3 mm (0.67±0.12")
100 GPD		254±2 mm (9.985±0.07")			
500 GPD			Ø 76±2 mm (2.992±0.07")		

Unit weight (net/gross), kg: 0.18/0.18
lb: 0.4/0.4

Box dimensions, m: 0.33 x 0.37 x 0.37
in: 13.0 x 14.6 x 14.6

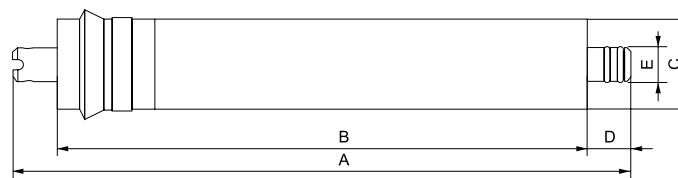

ECOSOFT RESIDENTIAL REVERSE OSMOSIS MEMBRANE ELEMENTS

Code	Product	Pieces in box	Boxes on pallet	Pieces on pallet
CSV181250ECO	Ecosoft 50 GPD membrane element	25	48	1 200
CSV181275ECO	Ecosoft 75 GPD membrane element	25	48	1 200
CSV1812100ECO	Ecosoft 100 GPD membrane element	25	48	1 200
CSV3012500ECO	Ecosoft 500 GPD membrane element	16	48	768

Minimum order is 1 pallet of any product